

OPERATIONS MANUAL

A-PT-051-PRO

Benchtop Welding Positioner

OPERATIONS MANUAL
AND REPLACEMENT PARTS LIST

From



Model: A-PT-051-PRO
Benchtop Welding Positioner

Serial Number: 1802010 ~ and Later

Sold By:



www.arc-zone.com
sales@arc-zone.com
(760) 931-1500



ArcZone



@ArcZone



@Arc_Zone



ArcZoneVideos



TABLE OF CONTENTS

Introduction	4
Safety Precautions.....	5
Limited Warranty.....	6
General Information.....	6
Specifications.....	7
Function.....	9
Installation / Operation	10
Parts List.....	11
Circuit Diagram.....	13

Introduction



WARNING

Any procedure, which not properly followed, may cause injury to the operator or others in the operating area.



WARNING

Carefully read this manual regarding rules for user safety before installing, operating, or servicing the equipment.

Equipment identification

The identification number, model, and serial number of this unit can be found on a nameplate attached to the control panel. Please record these numbers for future reference.

Receipt of equipment

Upon receiving the equipment, please check the shipping list. Make sure it is complete and inspect the equipment for possible damage during shipping. If there is any damage, notify the carrier immediately to file a claim.

Safety Precautions



WARNING

Please be warned that operation and maintenance of the system involve potential hazards. All operators and personnel should take precautions to prevent possible injury.

Electrical safety

Machine

- The counter, safety device against excess current and electrical installation, are compatible with its maximum power and its main voltage.
- The connection, single-phase or three-phase, is possible on a stand compatible with the plug of its cable link.
- If the cable is connected with the electrical network, the earth must never be cut by the protection device against electrical shocks.

Work Place

- Avoid contact between metal part and phase conductor and the neutral of electric network.
- Electrical messes of different electrical machine and apparatus are connected between themselves and with the terminal of earth neutral wire.

Interventions

- Before control and repair, see the apparatus is switched off and insulated.
- Connection with fixed installation cable is impossible.
- It's on "Stop" and connection is impossible.
- Some apparatus are provided with starting circuit HTHF (with a plate). Never enter into the corresponding switch cupboard.
- Only qualified persons are authorized for intervention concerning electrical installation

Maintenance

- Often check the insulation and connection good state of apparatus and electrical accessories: taps, appliance cords, coatings, switch, extension cords, etc.
- Maintenance and repair of insulating coatings operations are very important.
- Do repair with a specialist or better replace defective accessories.
- Check regularly the right adjustment and the non-heating of electrical connections.

Limited Warranty

UNITED PROARC CORPORATION warrants all new equipment to be free from defects in material and workmanship, provided that the equipment is installed and operated according to instructions stated in this manual.

UNITED PROARC CORPORATION's obligation under this warranty policy is expressly limited to the replace or repair, at its option, of the defected part only. ProArc's option to repair or replacement of a defected part under this warranty shall be based on FOB Taiwan basis.

UNITED PROARC CORPORATION shall not be liable for any loss or consequential damage or express accruing directly or indirectly from the use of equipment covered by this warranty. This warranty supersedes all previous ProArc warranties and is exclusive with no other guarantees or warranties expressed or implied.

This warranty excludes the consumable parts that are used in normal operation.

General Information

Features

1. High frequency interference tested.
2. Tilting angle ranged from 0~90o for different welding application.
3. Main shaft with $\varnothing 14$ mm through hole for pipe welding or shield gas.
4. Faceplate contains 3 straight slots for 3-jaws chuck (PG-050L, PG-095L) mounting. A centering guide is provided for quick installation with 3-jaws chuck option.

Specifications

Model	Unit	PT – 051
Power input	~	1 Phase,100~240VAC,50/60Hz, 2Amp
Capacity (Horizontal / Vertical)	kg	50 / 30
Rated eccentricity	mm	30
Table dimension (E)	mm	φ200
Rotation speed	rpm	0.5 ~ 8
Spindle thru hole	mm	φ14
Earthing	Amp	200
Tilt range	deg.	0 ~ 90
Overall length (A)	mm	320
Overall width (B)	mm	240
Overall height (C)	mm	265
Center to floor (D)	mm	205
Torque	Kg-cm	13 ~ 94
Net weight	kg	10

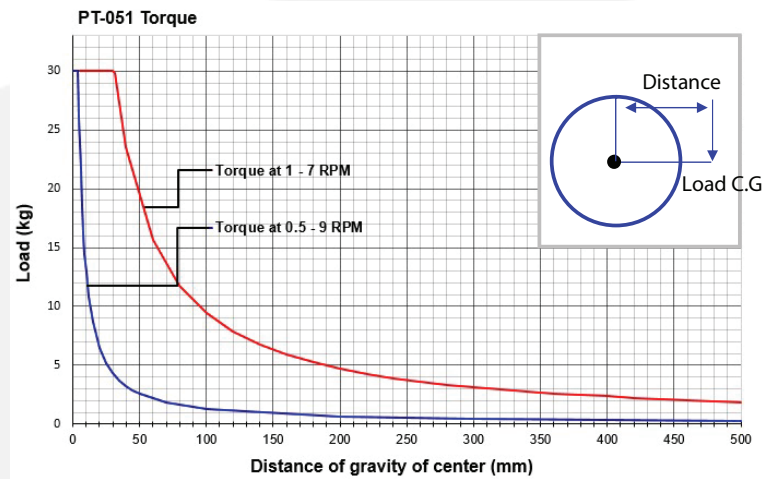
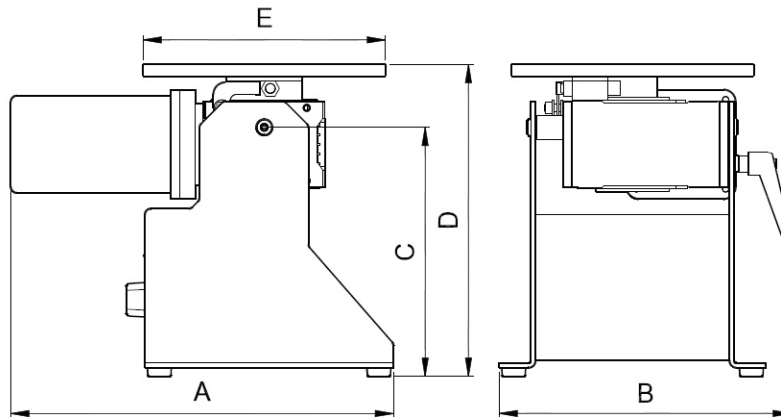

Function

No.	Description	No.	Description
1	Stop button.	6	Mounting Holes
2	Power switch.	7	Power cord / Power cord Adapter
3	Forward / Reverse switch	8	Foot Switch
4	Speed Adjustment Knob	9	Fuse Holder
5	Tilt Release / Locking Handle	10	Grounding Stud

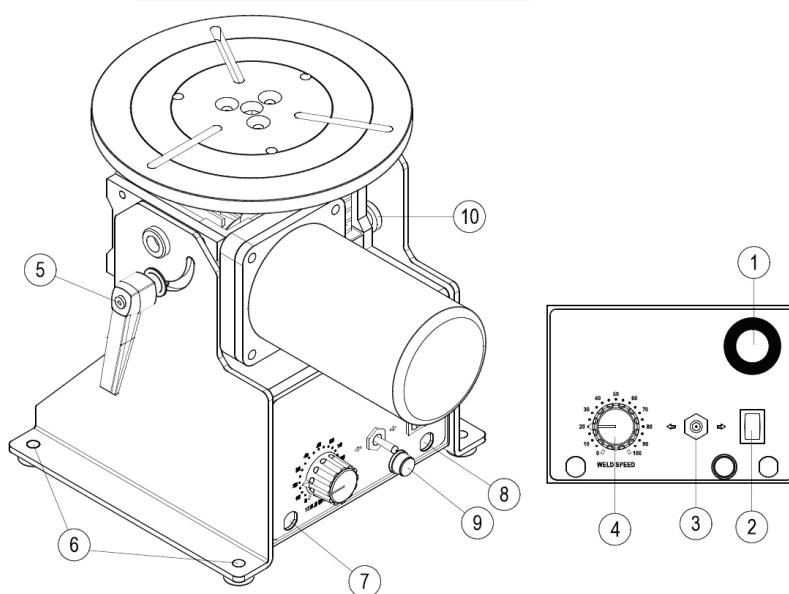

Installation / Operation

1. Power cord :

Connect power to 100V~240VAC single phase power.

Note: Standard power plug: NEMA 5-15P. Adapters are provided for region with different power socket.

NEMA-5-15P



European Adapter



Australian Adapter



2. Grounding stud :

Connect the grounding cable to system's grounding stud.

Warning: Unconnected grounding can cause system damage.

3. Tilt Release / Locking handle :

Turn clockwise to tighten/lock, turn counterclockwise to release.

Warning: Do not turn the locking handle while loads are present on the faceplate.

4. Power switch (SW1):

I = On, O = Off

5. Forward / Reverse switch (SW2):

Reverse (⇨) / Forward (⇩)

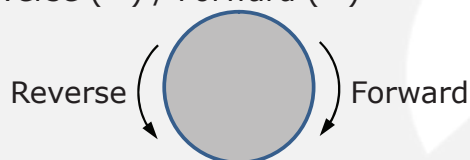

6. Stop:

Press the Stop button to pause all motion and disable all control.

Rotate the Stop button clockwise to reset.

7. Speed Adjustment Knob (VR1) :

Rotate clockwise to increase speed, counter clockwise to decrease speed.

8. Foot switch (F.S):

Steps onto the foot switch to start the faceplate rotation. Release the foot switch to stop the faceplate rotation.

9. Fuse holder (FS1):

Overload protection. Can be replaced by turning the knob clockwise to open the fuse cover.

Parts List

Item	Part No.	Description	Q'ty.	Remark
1	5005-1010000-10	Faceplate	1	
2	5005-1020000-10	Shaft	1	
3	5005-1030100-10	Panel	1	
4	5005-1050000-10	Tilting shaft	1	
5	5005-1060000-10	Tilting shaft	1	
6	5005-1070000-10	Tilting shaft	1	
7	5005-1080000-10	Side plate	1	
8	5005-1090000-10	Side plate	1	
9	* 5005-2010010-10	Carbon brush with case	1	
10	5005-3020000-11	Cover Plate	1	
11	* 0361-1009-9	PMDC Motor	1	
12	* 5005-0110000-10	Worm reducer	1	
13	0331-1207	Self-Lubricating bearing	2	
14	0140-0372	Machine mount	4	
15	0130-0121	Handle	1	
16	5034-5820900-10	Spacer 1	1	
17	3214-2009	E.S Push button	1	
18	3220-0002	Rocker switch	1	
19	3213-4007	Toggle switch	1	
20	3216-0006	Knob	1	
	3747-1001	Potentiometer	1	
21	* 3226-2002	Fuse	1	
	3226-0009	Fuse socket	1	
22	3325-0006	Power supply	1	
23	* 6651-1010	Motor speed control board	1	
24	3545-5001	Grounding copper bar	1	
25	3242-0007	Foot switch with cable 3M	1	
26	3445-0001	Power cord	1	Strand U.K (Option)
	3456-0005	Power cord	1	
27	3445-4002	Converter plug adapter	1	European adapter
28	3445-4001	Converter plug adapter	1	Australian adapter

* Recommended spare parts

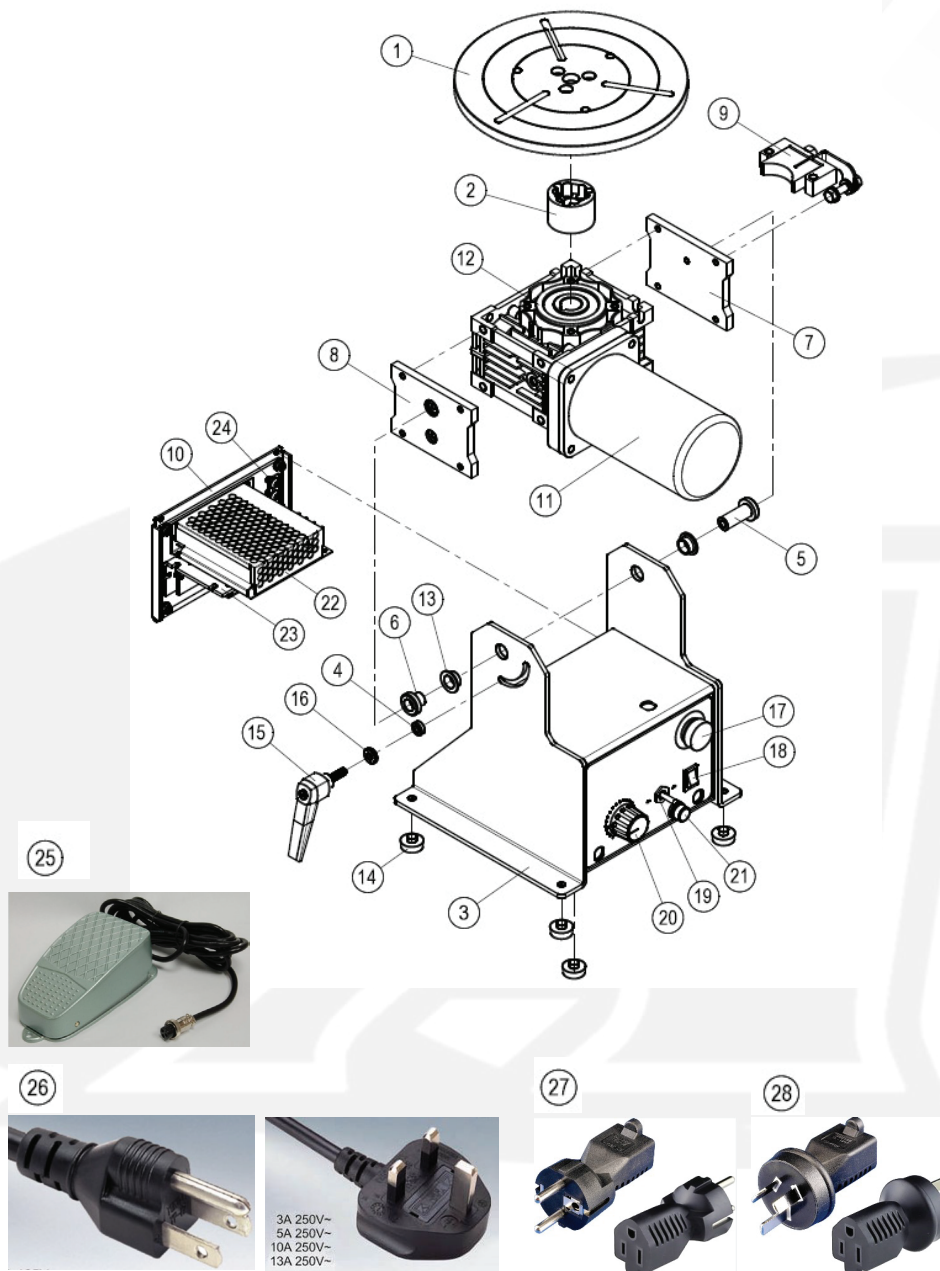

Circuit Diagram

